

MAYFAIR PERFORMANCE

PART NO.
137-8414/
137-8428

WARNING:
ATTACHING POWER TO ANY OTHER WIRE THAN THE RED
OR GREY WIRE WILL PERMENANTLY DAMAGE THE
SENDER AND DASH PANEL.

TITLE: GENERATION 1 VERSUS 2 TRIM
INDICATORS COMPARISON

www.mayfairperformance.com

GENERATION 1
137-8413 DASH PANEL 01/22 AND EARLIER
137-8428 TRIGGER SENDER 06/22 AND EARLIER

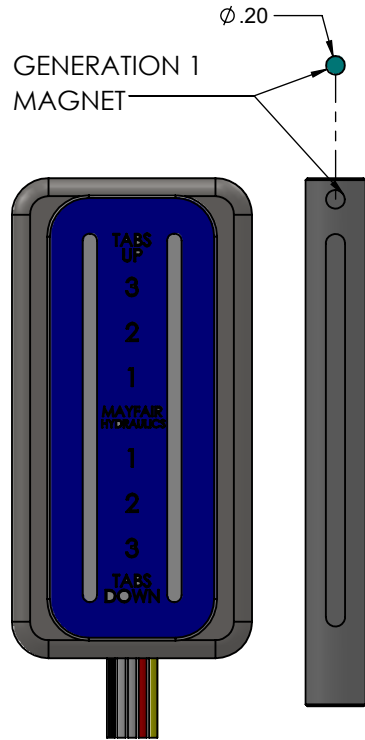

GEN 1 WIRING
WHITE: SENDER OUTPUT
BLACK: GROUND
RED: 12 VOLT POWER



GENERATION 2
137-8413 DASH PANEL 01/22 AND LATER
137-8414 TRIGGER SENDER 06/22 AND LATER

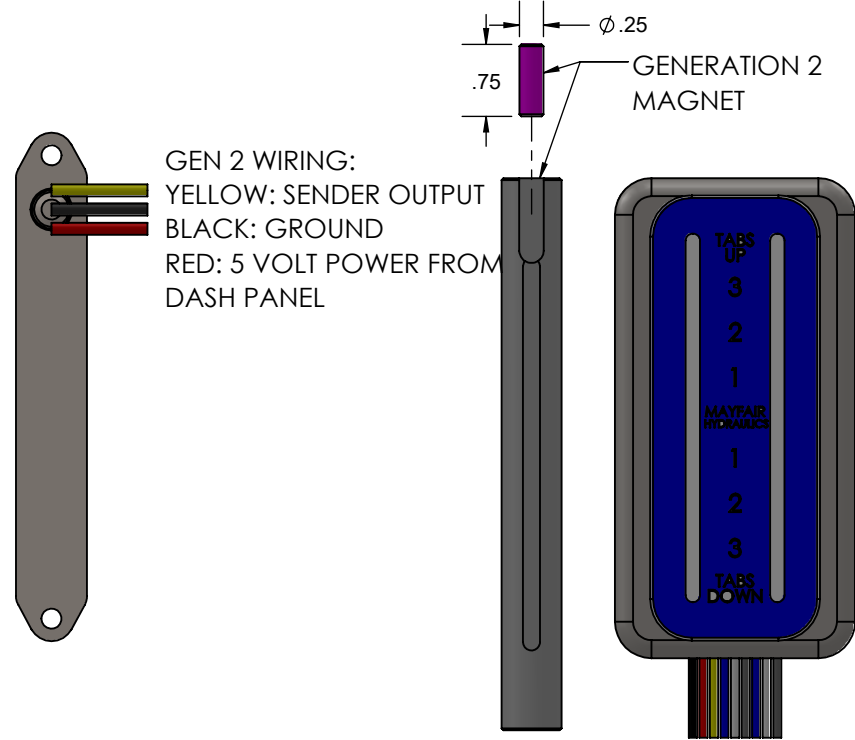

GEN 2 WIRING:
YELLOW: SENDER OUTPUT
BLACK: GROUND
RED: 5 VOLT POWER FROM
DASH PANEL

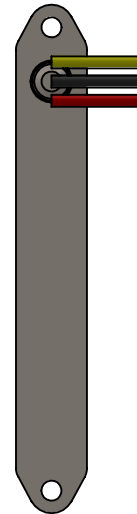

GEN 1 PANEL WIRING:
BLACK: GROUND
RED: 12 V/ 5AMP FUSED POWER
WHITE: SENDER INPUT
YELLOW: DASH LIGHTS

GEN 2 PANEL WIRING:
BLACK: PANEL GROUND
RED: 12 V/ 5AMP FUSED POWER
YELLOW: DASH LIGHTS
BLUE: SENDER GROUND
WHITE: SENDER INPUT
GREY: 5 VOLT POWER
BLUE: SENDER GROUND
WHITE: SENDER INPUT
GREY: 5 VOLT POWER

THIS DRAWING IS CONFIDENTIAL AND IS SUPPLIED ON EXPRESS CONDITION THAT IT SHALL NOT BE LENT, COPIED OR DISCLOSED TO ANY OTHER PERSON OR USED FOR ANY OTHER PURPOSE WITHOUT WRITTEN CONSENT OF HARDIN MARINE INC.. BREACH OF THIS CONTRACT WILL HOLD AND IT'S PRINCIPALS LIABLE FOR LOSS AND DAMAGES.